

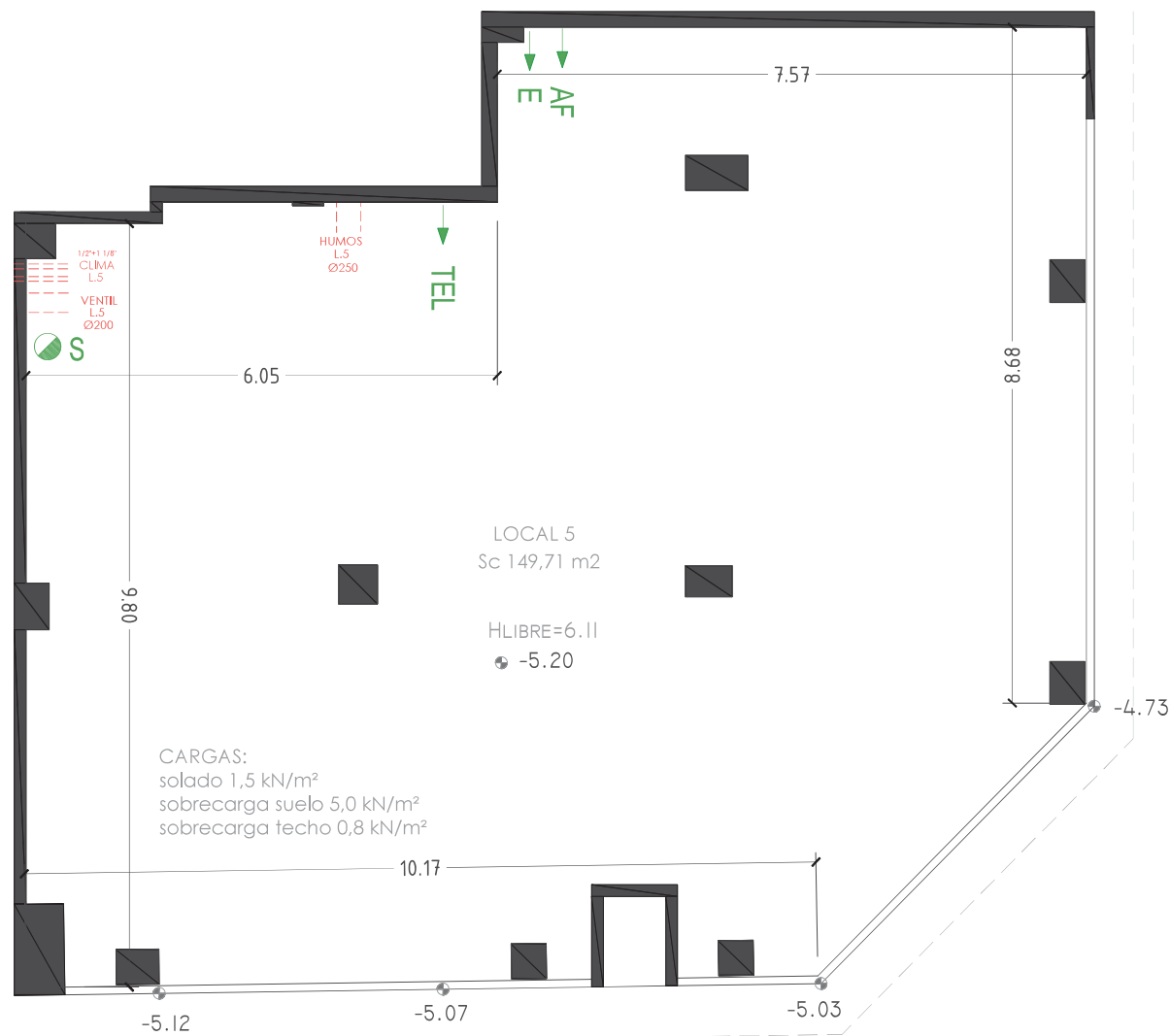

LOCALES COMERCIALES

LOCAL 5

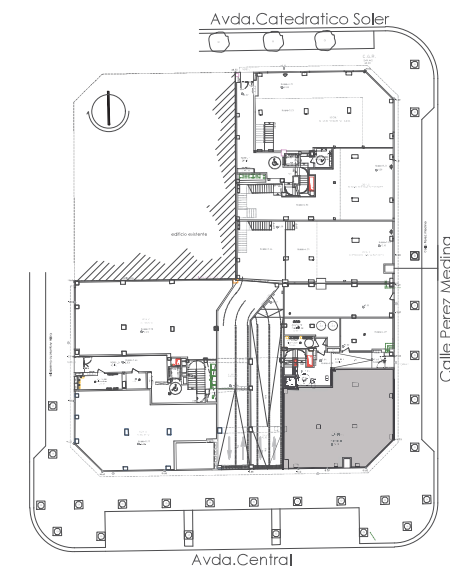





SUPERFICIE CONSTRUIDA 149,71



CARGAS:
solado 1,5 kN/m²
sobrecarga suelo 5,0 kN/m²
sobrecarga techo 0,8 kN/m²

LOCAL 5
Sc 149,71 m²
HLIBRE=6.11
± -5.20

VENTILACIÓN

-  TUBO Ø250 HUMOS
-  TUBO VENTILACIÓN
-  2 TUBOS DE COBRE CALORIFUGADOS DE 1/2" + 1 1/8"
-  PREVISIÓN SANEAMIENTO
-  ACOMETIDA AGUA FRÍA
-  ACOMETIDA TELECOMUNICACIONES
-  ACOMETIDA ELECTRICIDAD

ACCESO ↑